

C 184-100-

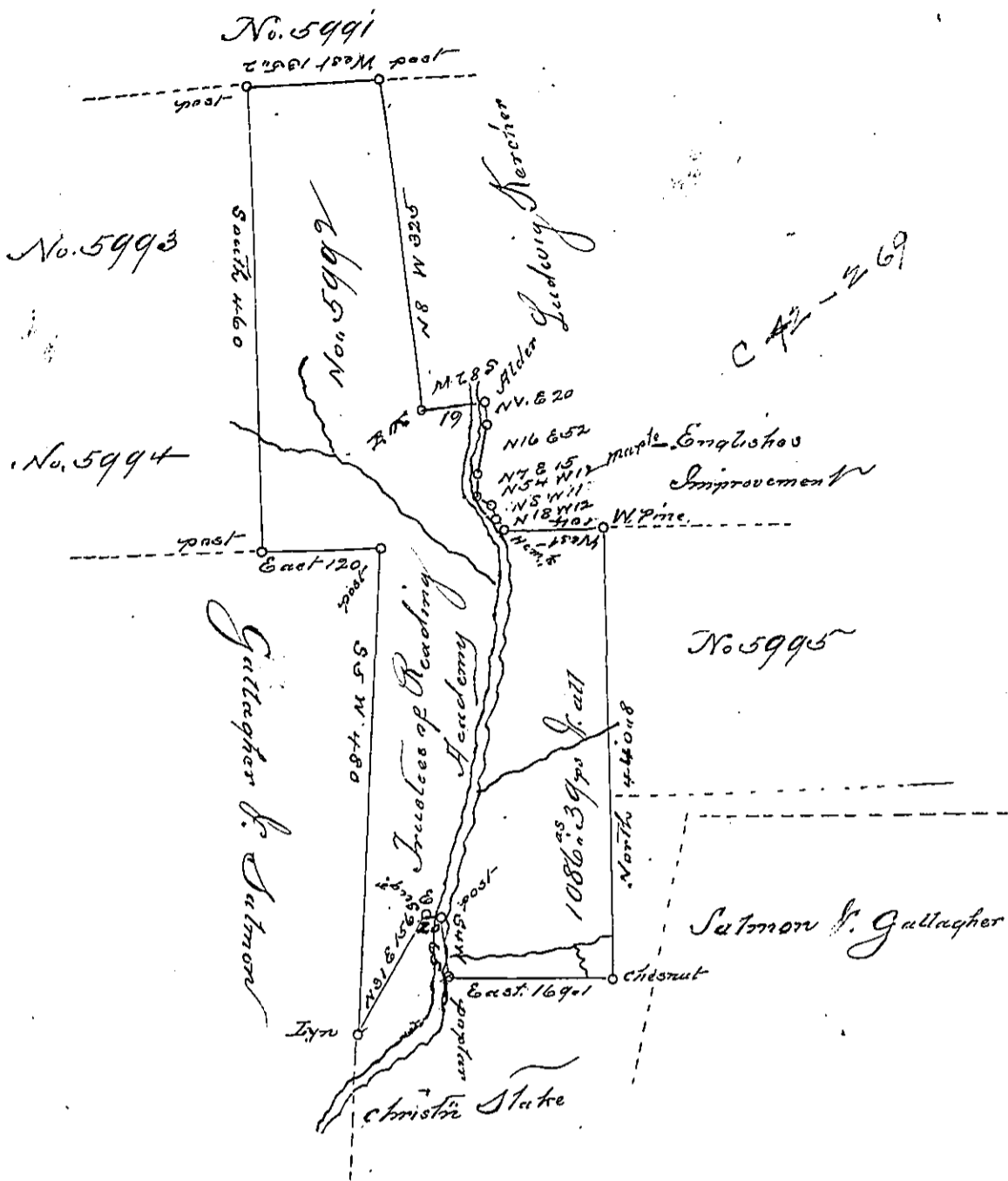

Deed of a tract of land situate on the first fork of Pine-creek about one mile from its mouth in Mifflin Township Lycoming County, Surveyed on the 17th Sept 1814, for the Trustees of the Reading Academy in pursuance of their Warrant No. 5992 dated the 5th day of Sept 1805. Containing One Thousand and eighty six acres Thirty nine perches & Allowance of six per Ct. Late Purchase

Wm. Wilson

To Richd. J. Leach Esqr.
Surveyor General

IN TESTIMONY that the above is a copy of the original remaining on file in the Department of Internal Affairs of Pennsylvania, made conformably to an Act of Assembly approved the 16th day of February, 1833, I have hereunto set my Hand and caused the Seal of said Department to be affixed at Harrisburg, this

Ninth day of April 1891

Thos. J. Stewart
Secretary of Internal Affairs